











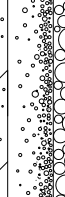



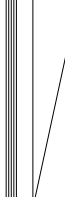
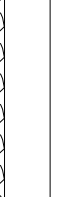

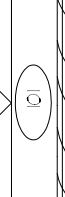
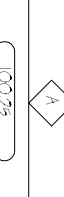
SYMBOL LEGEND

MARK	DESCRIPTION
	EARTH
	GRAVEL
	CONCRETE (CONC.)
	CONCRETE BLOCK (C.M.U.)
	STEEL
	FINISHED WOOD
	ROUGH CUT WOOD
	WOOD BLOCKING
	WOOD STUDS
	BATT INSULATION
	RIGID INSULATION
	PLYWOOD
	DOOR DESIGNATION
	WINDOW DESIGNATION
	SITE ELEVATION DESIGNATION
	DETAIL REFERENCE
	COLUMN DESIGNATION
	BRICK
	
	

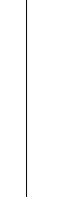
PROJECT LOCATION MAP

Project:

RESIDENTIAL UNIT NO. 1064ES-B

12.03.10

DEVELOPER: Kriss Lowry and Associates, Inc.

227 South Rays Fork Road
 Corinth, Kentucky 41010-3027
 Ph. (502)-857-2800

ARCHITECT: Randall C. Burchett

233 West Court Street, Suite 200
 Prestonsburg, Ky. 41653
 PH. 606/886-3929 FAX. 606/886-0289

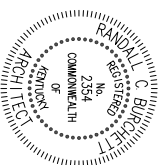

INDEX OF DRAWINGS

SHEET	DESCRIPTION
TL	TITLE SHEET/DATA
A--1	COMPOSIT FLOOR PLAN
A--2	FOUNDATION PLAN
A--3	ELEVATIONS
A--4	ELEVATIONS
A--5	TYPICAL WALL SECTION
	TYPICAL WALL SECTION

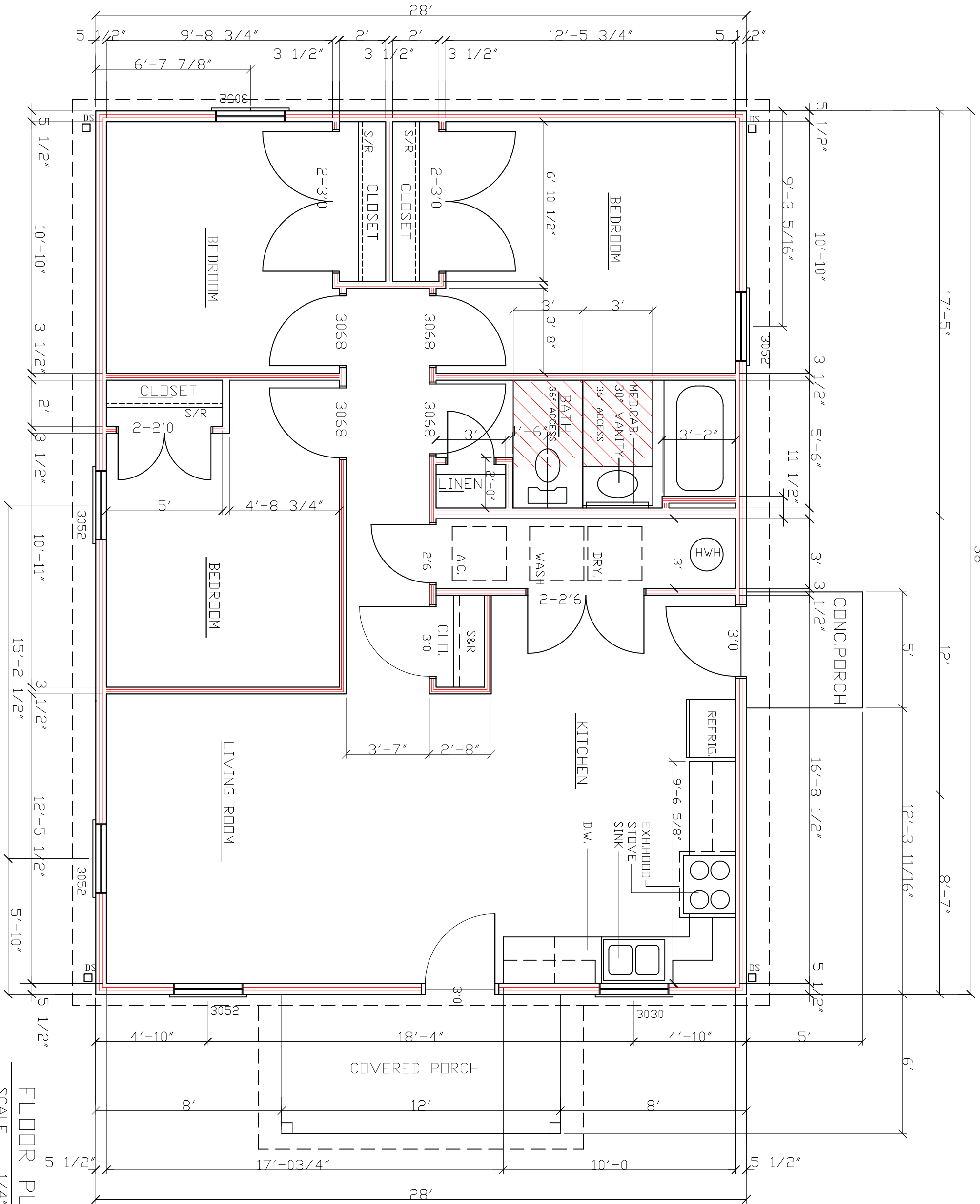

FLOOR PLAN

SCALE 1/4" = 1'-0"

FLOOR PLAN NOTES:

- STUD WALLS 2X6 (5-1/2") @16" OR 24" O.C.
 - PLUMBING WALLS 2X6 (5-1/2") @16" O.C.
 - FINISHED CEILING 8'-0" A.F.F.
 - LOAD BEARING HEADERS (2) 2X10 W/ 1/2" PLYWOOD AND 2X4 BASE MIN. DIMENSIONS TAKEN FROM FACE OF STUDS OR FOUNDATION
 - ALL DOORS STANDARD HEIGHT UNLESS NOTES
 - EXTERIOR DOORS TO HAVE EXTENDED JAMBS DESIGNED FOR 2X6 WALLS
- PROVIDE AT EACH BEARING LOCATION OF EACH ROOF TRUSS A METAL TIE-DOWN STRAP (HURRICANE CLIP). THE TIE-DOWN SHALL BE INSTALLED BEFORE WALL SHEATHING ON EXTERIOR. THE TIE-DOWN STRAP MUST LAP THE TOP CHORD OF THE TRUSS BY AT LEAST 2 INCHES AND THE TOP PLATE OF THE WALL PROVIDE THE CORRECT NAILS AND NAILING PATTERN THAT IS REQUIRED BY THE MANUFACTURER OF THE METAL TIE-DOWN STRAP.

KRISS LOWRY & ASSOCIATES, INC.
CORINTH, KY

1064ES-B



RANDALL C. BURCHETT & ASSOCIATES
ARCHITECT
322 WEST COURT ST. PRESTONSBURG, KENTUCKY 41653
PH. 606.886.3929 FAX. 606.886.0289

DATE:	12.03.10
REVISED:	
REVISIONS:	
DRAWN BY:	RCB
JOB NO.:	1064ES-B

SHEET NUMBER



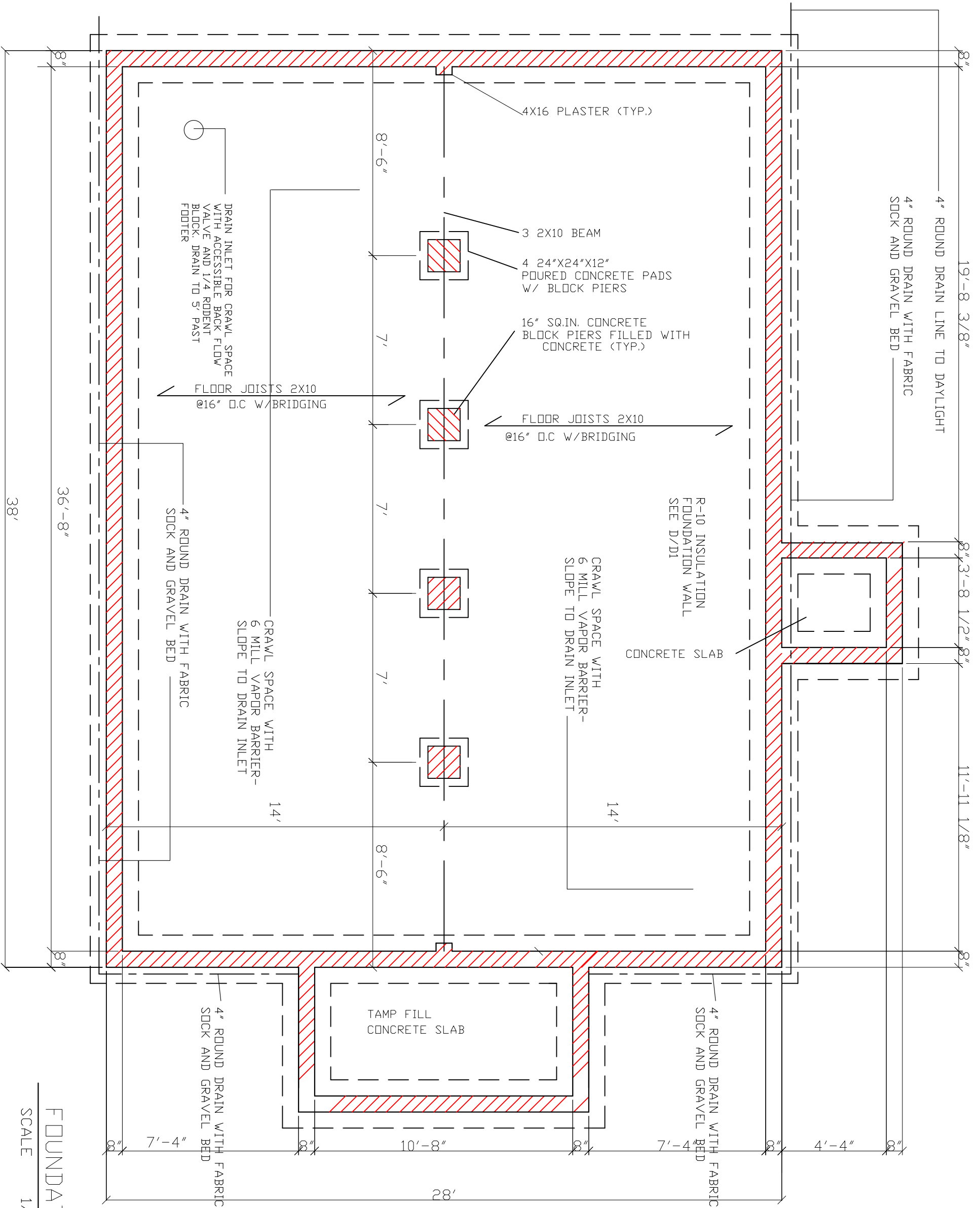

DRAIN INLET FOR CRAWL SPACE WITH ACCESSIBLE BACK FLOW VALVE AND 1/4 RODENT BLOCK. DRAIN TO 5' PAST FOOTER

FLOOR JOISTS 2X10 @16" O.C W/BRIDGING

FLOOR JOISTS 2X10 @16" O.C W/BRIDGING

4" ROUND DRAIN WITH FABRIC SOCK AND GRAVEL BED

CRAWL SPACE WITH 6 MILL VAPOR BARRIER-SLOPE TO DRAIN INLET

CRAWL SPACE WITH 6 MILL VAPOR BARRIER-SLOPE TO DRAIN INLET

R-10 INSULATION FOUNDATION WALL SEE D/D1

CONCRETE SLAB

TAMP FILL CONCRETE SLAB

4" ROUND DRAIN WITH FABRIC SOCK AND GRAVEL BED

4" ROUND DRAIN WITH FABRIC SOCK AND GRAVEL BED

FOUNDATION PLAN NOTES:

- SURFACE FINISHED WITH CRUSHED STONE AND POLY V.B.
- FOUNDATION WALL 8" CONCRETE BLOCK W/ 2X8 SILL PLATE BOLTED W/ ANCHOR BOLTS @ 48" O.C.
- FOOTING 18X8 Poured concrete with (2) #4 REBAR
- CONCRETE SLABS 4" REINFORCED W/ 6X6 10/10 W.W.F. ON 6 MIL. POLY AND 4" CRUSHED STONE.
- DOUBLE JOISTS UNDER PARALLEL PARTITIONS.
- BLOCKING OR BRIDGING WITH JOISTS WHERE NEEDED.

DATE:	12.03.10
REVISED:	
REVISED:	
REVISED:	
DRAWN BY:	RCB
JOB NO.:	1064ES-B



RANDALL C. BURCHETT & ASSOCIATES
ARCHITECT
 322 WEST COURT ST. PRESTONSBURG, KENTUCKY 41653
 PH. 606.886.3929 FAX. 606.886.0289

KRISS LOWRY & ASSOCIATES, INC.
 CORINTH, KY 1064ES-B

FOUNDATION PLAN

SCALE 1/4" = 1'-0"

SHEET NUMBER

2A

CLASS 'A' FIBERGLASS SHINGLES
OVER 30 LBS FELT OVER 7/16"
OSB SHEATHING WITH "H" CLIP

5" PRE-FINISHED ALUMDIBEE
GUTTER

VINYL DOUBLE HUNG WINDOW
WITH INSULATED GLASS AND
INSECT SCREEN

CORNER BOARD

4" BEVELED VINYL SIDING
OVER TYVEK HOUSE WRAP
ON 7/16" OSB SHEATHING

GRADE

FOOTER/FOUNDATION
SYSTEM BELOW

FRONT ELEVATION

SCALE 1/4" = 1'-0"

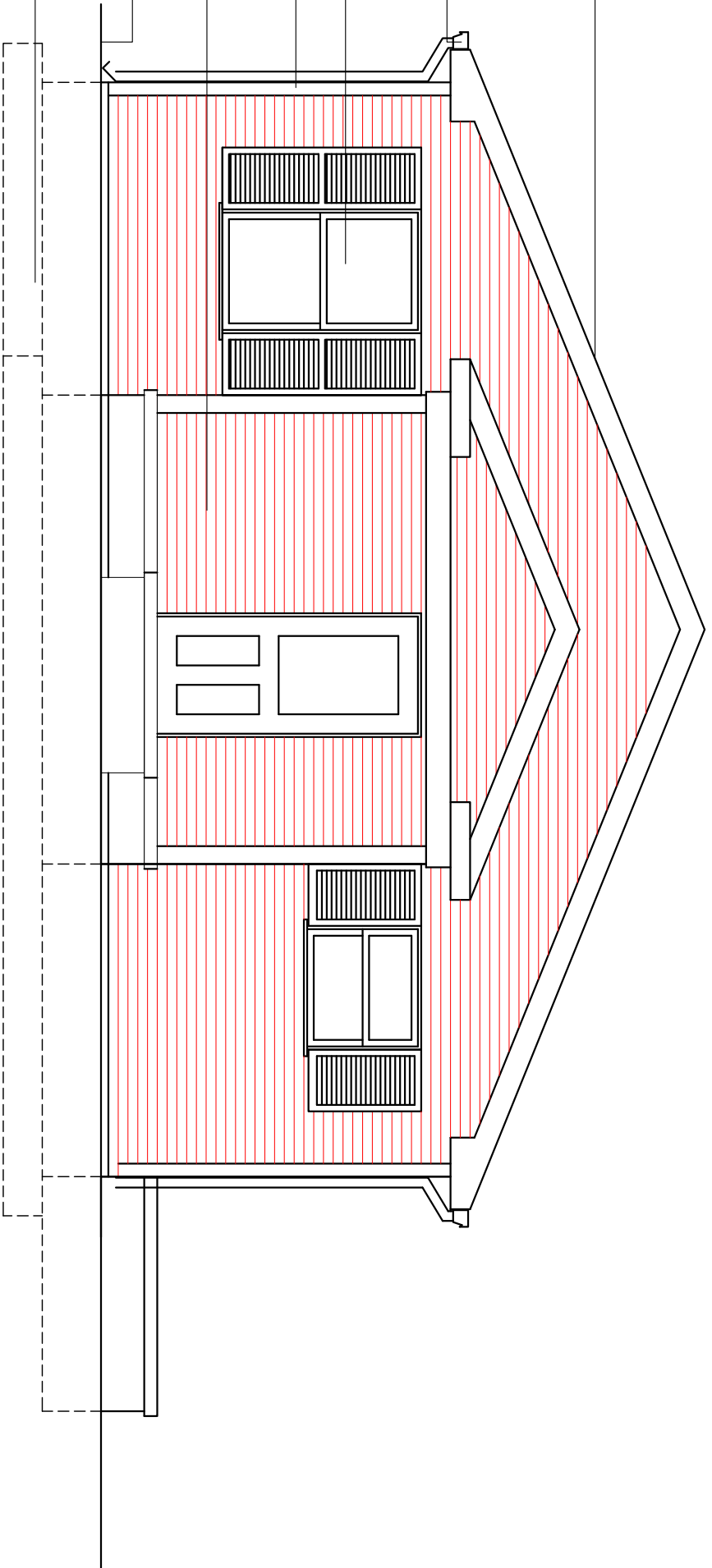

CLASS 'A' FIBERGLASS SHINGLES
OVER 30 LBS FELT OVER 7/16"
OSB SHEATHING WITH "H" CLIP

5" PRE-FINISHED ALUMDIBEE
GUTTER

CORNER BOARD

4" BEVELED VINYL SIDING
OVER TYVEK HOUSE WRAP
ON 7/16" OSB SHEATHING

GRADE

FOOTER/FOUNDATION
SYSTEM BELOW

REAR ELEVATION

SCALE 1/4" = 1'-0"

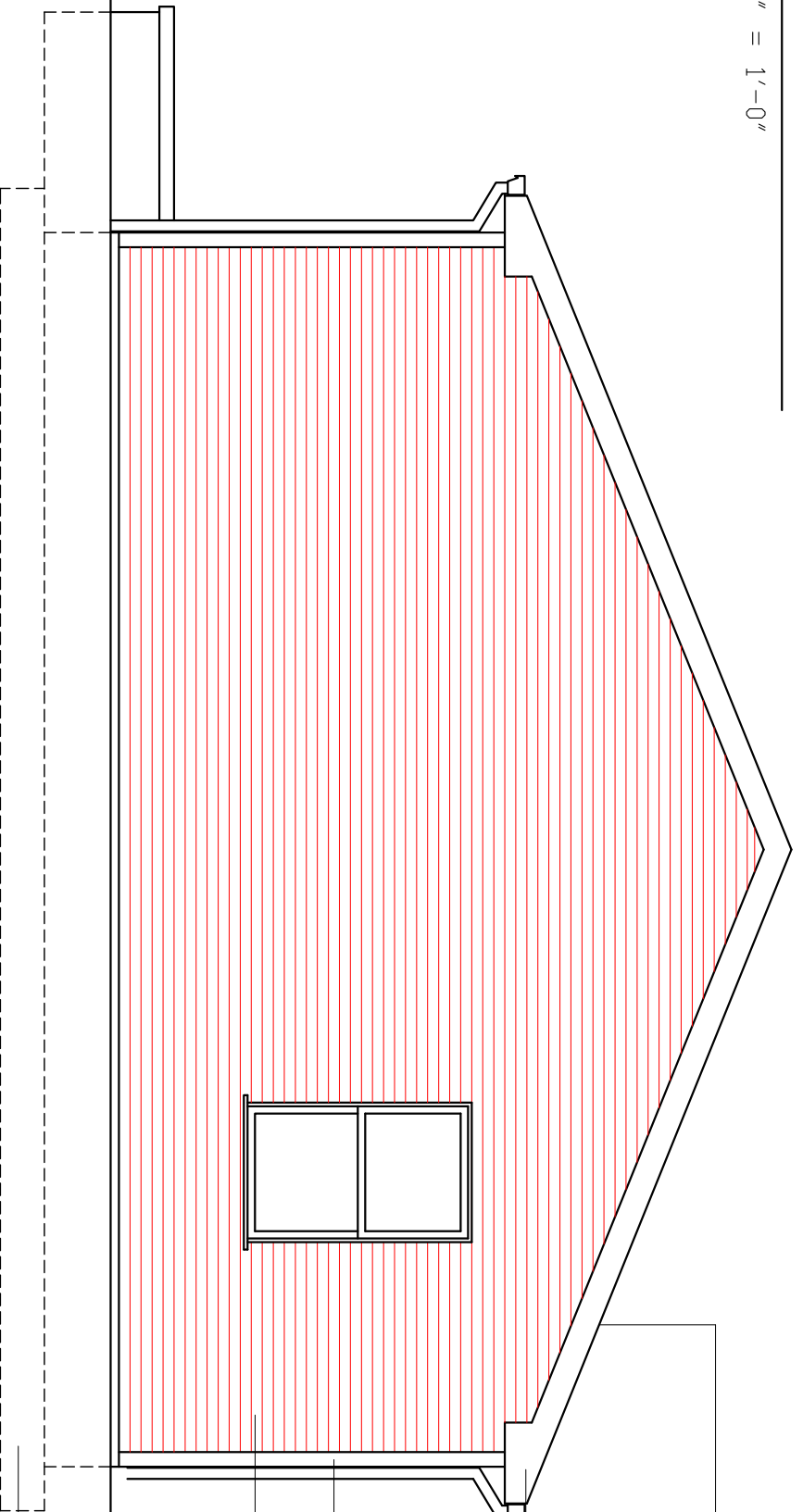

DATE: 12.03.10
REVISED:
REVISED:
DRAWN BY: RCB
JOB NO: 1064ES-B

RANDALL C. BURCHETT & ASSOCIATES
ARCHITECT
322 WEST COURT ST. PRESTONSBURG, KENTUCKY 41653
PH. 606.886.3929 FAX. 606.886.0289

KRISS LOWRY & ASSOCIATES, INC.
CORINTH, KY 1064ES-B

AS
SHEET NUMBER

CONT. RIDGE VENT

CLASS "A" FIBERGLASS SHINGLES
OVER 30 LBS FELT OVER 7/16"
DSB SHEATHING WITH "H" CLIP

5" PRE-FINISHED ALUM.DBEE
GUTTER

VINYL DOUBLE HUNG WINDOW
WITH INSULATED GLASS AND
INSECT SCREEN

CORNER BOARD

4" BEVELED VINYL SIDING
OVER TYVEK HOUSE WRAP
ON 7/16" DSB SHEATHING

PRE-FINISHED ALUM.
DOWNSPOUT TIE TO DRAIN
BOOT AND 4"PIPE DRAIN

GRADE

FOOTER/FOUNDATION
SYSTEM BELOW

LEFT SIDE ELEVATION

SCALE 1/4" = 1'-0"

CONT. RIDGE VENT

CLASS "A" FIBERGLASS SHINGLES
OVER 30 LBS FELT OVER 7/16"
DSB SHEATHING WITH "H" CLIP

5" PRE-FINISHED ALUM.DBEE
GUTTER

VINYL DOUBLE HUNG WINDOW
WITH INSULATED GLASS AND
INSECT SCREEN

CORNER BOARD

4" BEVELED VINYL SIDING
OVER TYVEK HOUSE WRAP
ON 7/16" DSB SHEATHING

PRE-FINISHED ALUM.
DOWNSPOUT TIE TO DRAIN
BOOT AND 4"PIPE DRAIN

GRADE

FOOTER/FOUNDATION
SYSTEM BELOW

RIGHT SIDE ELEVATION

SCALE 1/4" = 1'-0"

DATE: 12.03.10

REVISED:

REVISED:

DRAWN BY: RCB

JOB NO.: 1064ES-B

RANDALL C. BURCHETT & ASSOCIATES
ARCHITECT
322 WEST COURT ST. PRESTONSBURG, KENTUCKY 41653
PH. 606.886.3929 FAX. 606.886.0289



KRISS LOWRY & ASSOCIATES, INC.
CORINTH, KY

1064ES-B

SHEET NUMBER



PRE-ENGINEERED WOOD ENERGY
HEEL TRUSSES W/12" HEEL AT 24"
C/C OR AS NOTED ON TRUSS
MANUFACTURERS INSTALLATION DWGS.

BLOCKING AS REQUIRED

R-38 BLOWN INSULATION

5/8" GYPSUM BOARD

1/2" GYPSUM BOARD

2X6 WOOD STUDS AT 24" C/C SPF

2-2X10 HEADER

WOOD STOOD

WOOD CASEMENT SEAL PERIMETER

R-19 FIBERGLASS BATT INSULATION

BETWEEN STUDS. FILL VOIDS

ADVANTECH SUB-FLOORING
GLUE AND NAIL

TREATED 2X6 SILL PLATE OVER FOAM WITH
SEALER STRIP

1/2" DIA. X 12" LONG ANCHOR BOLT
AT 48" C/C
6 MIL VAPOR RETARDER ON INSIDE
OF CMU AND FLOOR

R-10 RIGID INSUL. SECURE TO CMU

4" LAYER OF #9 GRAVEL OR EQUAL,
6 MIL VAPOR BARRIER OVER GRAVEL,
SLOPE CRAWL SPACE FLOOR TO THE
CRAWL SACE DRAIN

CLASS "A" FIBERGLASS SHINGLES
OVER 30#FELTS OVER 7/16" OSB
SHEATHING WITH "H" CLIPS
2J STYROFOAM BAFFLES

CONT.INSULATIN BAFFEL

CONTINUOUS ALUMINUM DRIP EDGE

5' PRE-FINISHED ALUMINUM GUTTER

2X6 FACIA SFFFIT WITH PRE-FINISHED

DOUBLE TOP PLATES

ALUMINUM CLAD FACE

CONTINUOUS PERFERATED VINYL SOFFITTT

VINYL "S" CHANNEL

VINYL DOUBLE HUNG WINDOW WITH
INSULATED GLASS AND INSECT SCREEN

SEE SHEET A-2

VINYL UTILITY TRIM

CONTINUOUS SEALANT AROUND ALL
WINDOW TRIM

4" BEVELED VINYL SIDING OVER TYVEK
HOUSE WRAP ON 7/16" OSB SHEATHING

2X6 PLATE WITH SEALANT BETWEEN
PLATES AND PLYWOOD

2X10 BAND JOIST

NOTE: BAND JOIST SHALL BE INSULATED WITH PAPER
FACED R-30 INSULATION EXTENDING TO THE OUTER EDGE OF FOAM INSULATIN

2X10 FLOOR JOISTS AT 16" C/C

6 MIL VAPOR RETARDER ON INSIDE OF CMU AND FLOOR

8" CMU FOUNDATION FILLED SOLID BELOW GRADE
SEE SHEET A-3

BITUMINOUS DAMP PROOFING BELOW GRADE

4" PERFORATED DRAIN PIPE WITH FABRIC
SOCK AND MIN. 10" OF TOP GRAVEL. DRAIN
LINE MUST BE BELOW CRAWL SPACE FLOOR.

CONT. CONCRETE FOOTING REINFORCED WITH (2)
#4 BARS CONT. AND #4 REBAR PERPENDICULAR
@ 4' C/C-SEE FOUNDATION PLAN SHEET A-3

TYPICAL WALL SECTION

SCALE 1/2" = 1'-0"

DATE:	12.02.10
REVISED:	02.04.11
REVISED:	
DRAWN BY:	RCB
JOB NO.:	ES-A



RANDALL C. BURCHETT & ASSOCIATES
ARCHITECT
235 WEST COURT STREET, PRESTONSBURG, KENTUCKY 41653
PH. 606.836.2929 FAX. 606.836.0239

KRISS LOWRY & ASSOCIATES, INC.
CORINTH, KY

SHEET NUMBER

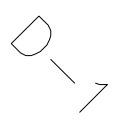



- PORCH NOTES:**
- EACH EXTERIOR DOOR A MIN. 60" X 60" LANDING. LANDING NO MORE THAN 1'-1/2" BELOW TOP OF THRESHOLD.
 - ALL PORCHES AND LANDINGS TO BE OF CONCRETE CONSTRUCTION.
 - TREATED WOOD PORCHES ALLOWED W/ PROJECT MANAGERS APPROVAL

- LANDING NOTES:**
- ALL PORCHES W/ FLOORS MORE THAN 30" ABOVE THE FINISH GRADE ANYWHERE TO HAVE GUARDRAILS. OPEN SIDES OF STAIRS W/ TOTAL RISE MORE THAN 30" TO HAVE A GUARD RAIL.
 - TOP OF GUARDRAILS TO BE MIN. 34" MAX. 38" ABOVE FLOOR SURFACE.

- STAIRS NOTES:**
- TRIANGULAR SHAPE BETWEEN TREAD AND BOTTOM RAIL NOT TO ALLOW A 6" DIAM. SPHERE THROUGH. PORCH STEPS TO HAVE 42" NET CLEAR WIDTH.
 - MAX. RISER HEIGHT TO BE 7" MIN. TREAD TO BE 11"
 - ALL STAIRWAYS OF 3 OR MORE RAISERS TO HAVE A HANDRAIL ON AT LEAST ONE SIDE.
 - ALL HANDRAILS TO BE CONTINUOUS THE FULL LENGTH OF STAIRS. ENDS TO BE RETURNED OR TERMINATED IN NEVEL POST OR SAFETY TERMINAL.
 - HANDRAILS ADJACENT TO A WALL SHALL HAVE A SPACE NOT LESS THAN 1-1/2" BETWEEN THE TWO HANDRAILS INTERRUPTED BY NEVEL POST AT TURN ONLY
 - SIZE OF HANDRAILS: 1-1/2" - 2" DIAM. OR MAX. 2-1/4" CROSS
 - HANDRAILS SHALL BE SOLIDLY FIXED
 - SPACE BETWEEN SPINDLES 4" MAX.
 - ALL FRONT PORCHES 6X12' UNLESS SPEC'D BY P.M.
 - ALL PORCH STAIRS TO HAVE THREE (3) 2" X 12" STRINGERS.
 - PORCH STEPS SHALL HAVE A CONCRETE PAD TO SUPPORT STAIR CARRIAGE THAT LEAVES A 4" X 4" CLEAR LANDING @ BASE OF STEPS
 - ALL EXTERIOR HANDRAILS TO BE 1-1/2" PAINTED PIPE OR SMOOTH METAL MOUNTED USING STANDARD HANDRAIL BRACKETS.

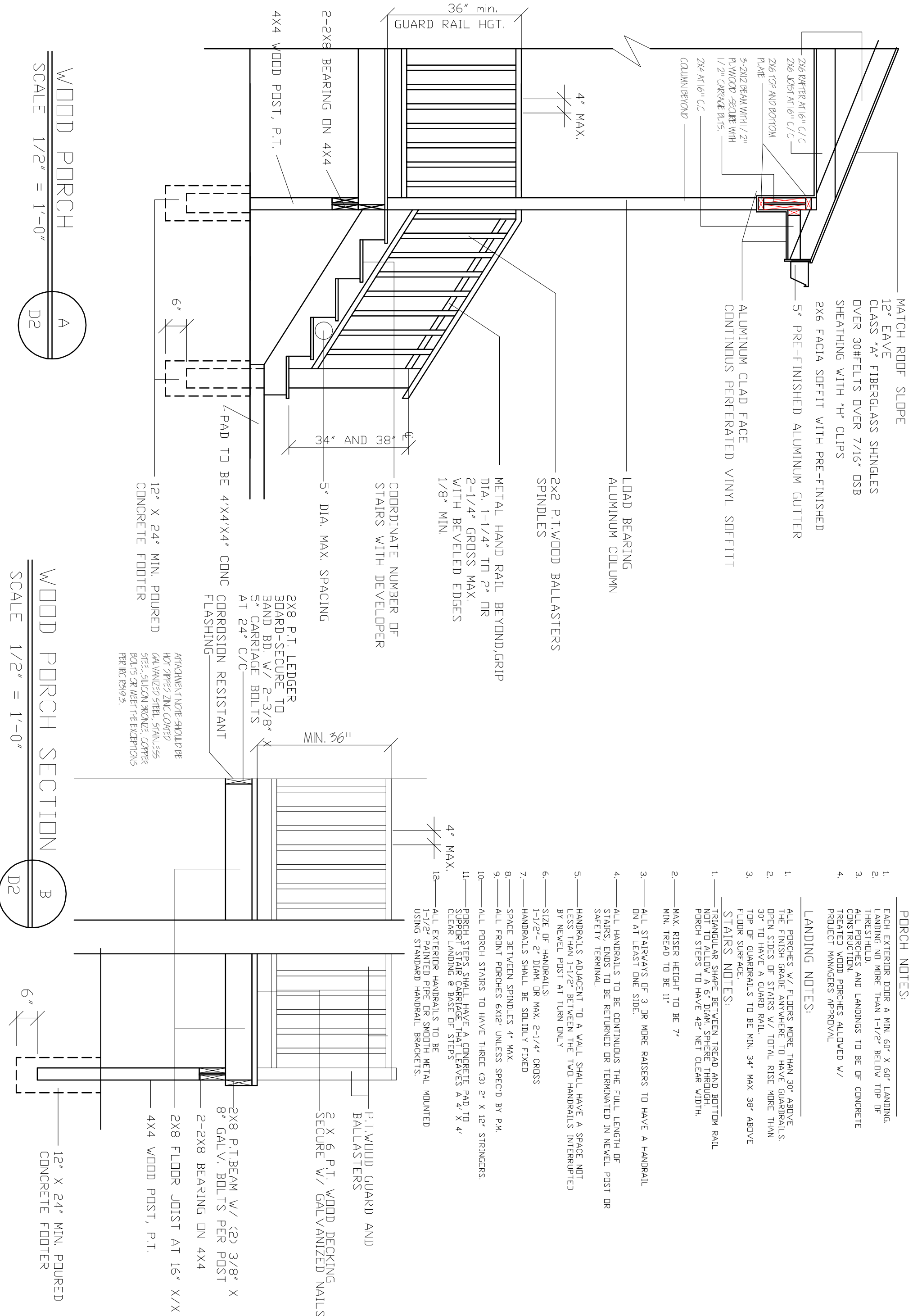

WOOD PORCH
 SCALE 1/2" = 1'-0"

WOOD PORCH SECTION
 SCALE 1/2" = 1'-0"

MATCH ROOF SLOPE

CLASS "A" FIBERGLASS SHINGLES
OVER 30HELTS OVER 7/16" OSB
SHEATHING WITH "H" CLIPS

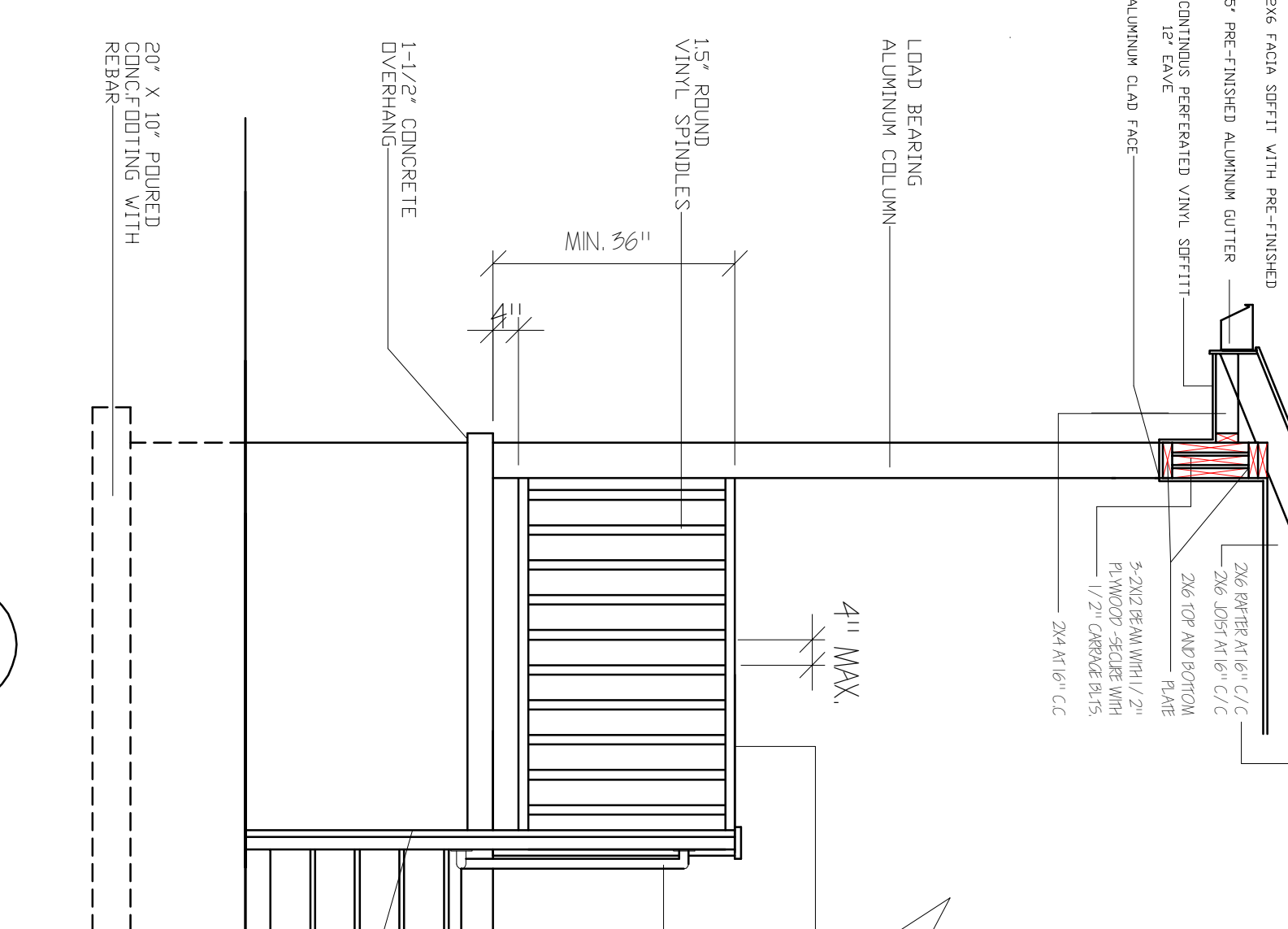

HANDRAIL CONNECTION DETAIL
NT5.

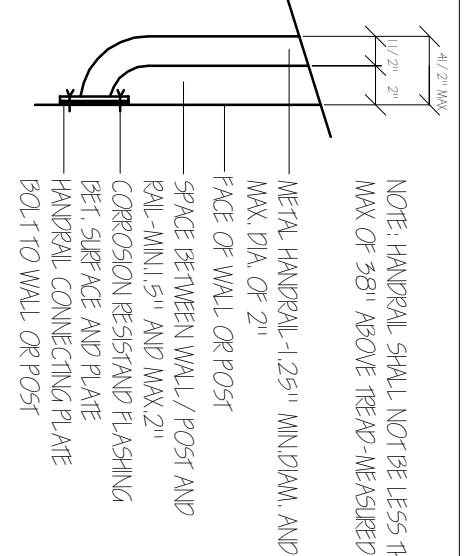

NOTE: HANDRAIL SHALL NOT BE LESS THAN 34" AND
MAX OF 38" ABOVE TREAD - MEASURED VERTICALLY

VINYL TOP RAIL GRIP SIZE
DIA. 1-1/4" TO 2" OR
2-1/4" GROSS MAX.
WITH BEVELED EDGES
1/8" MIN.

METAL HANDRAIL, MIN 34"
MAX-38"
SEE SHEET D-2

PORCH SLABS TO INCLUDE:
4" MIN. THICKNESS
6" WIRE MESH
CRUSHED STONE GRADED 1/4" - 3/4"
COVERED WITH VAPOR BARRIER
EXP. JOINTS @ WALLS
1-1/2" OVERHANDS
1/8" / 12" SLOPE AWAY FROM HOUSE

4X4 VINYL POST
SET IN CONCRETE

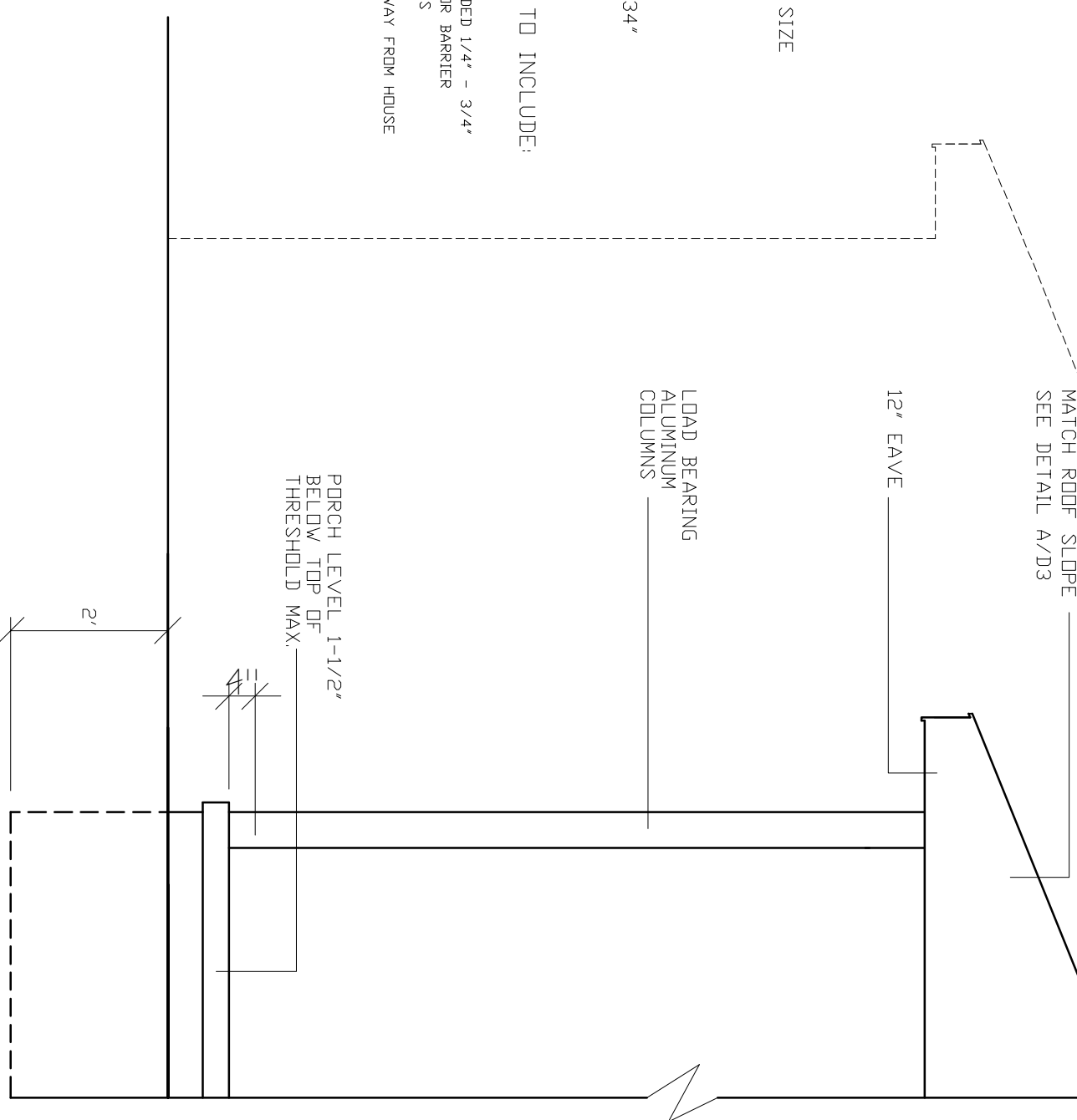

PORCH LEVEL 1-1/2"
BELOW TOP OF
THRESHOLD MAX.

RAISED PORCH SLAB

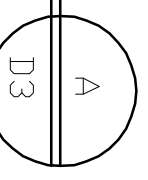

SCALE 1/2" = 1'-0"

@GRADE PORCH SLAB

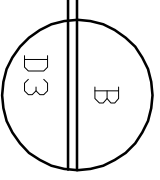

SCALE 1/2" = 1'-0"

DATE:	11.11.11
REVISED:	
REVISD:	
REVISD:	
DRAWN BY:	RCB
JOB NO:	ES-A



RANDALL C. BURCHETT & ASSOCIATES
ARCHITECT
233 WEST COURT STREET, PRESTONSBURG, KENTUCKY 41653
PH. 606.886.3929 FAX. 606.886.0289

KRISS LOWRY & ASSOCIATES
CORINTH, KY

SHEET NUMBER

