

PORCHES NOTES:

1. EACH EXTERIOR DOOR A MIN. 60" x 60" LANDING.
2. LANDING NO MORE THAN 1-1/2" BELOW TOP OF THRESHOLD.
3. ALL PORCHES AND LANDINGS TO BE OF CONCRETE CONSTRUCTION.
4. TREATED WOOD PORCHES ALLOWED W/ PROJECT MANAGER'S APPROVAL.

LANDING NOTES:

1. ALL PORCHES W/ FLOORS MORE THAN 30" ABOVE THE FINISH GRADE ANYWHERE TO HAVE GUARDRAILS.
2. OPEN SIDES OF STAIRS W/ TOTAL RISE MORE THAN 30" TO HAVE A GUARD RAIL.
3. TOP OF GUARDRAILS TO BE MIN. 34" MAX. 38" ABOVE FLOOR SURFACE.

STAIRS NOTES:

1. TRIANGULAR SHAPE BETWEEN TREAD AND BOTTOM RAIL NOT TO ALLOW A 6" DIAM. SPHERE THROUGH.
2. PORCH STEPS TO BE MIN. 48" WIDE EXCEPT AS NOTED BY P.M. MAX. RISER HEIGHT TO BE 7" MIN. TREAD TO BE 11"
3. ALL STAIRWAYS OF 3 OR MORE RAISERS TO HAVE A HANDRAIL ON AT LEAST ONE SIDE.
4. ALL HANDRAILS TO BE CONTINUOUS THE FULL LENGTH OF STAIRS, ENDS TO BE RETURNED OR TERMINATED IN NEWEL POST OR SAFETY TERMINAL.
5. HANDRAILS ADJACENT TO A WALL SHALL HAVE A SPACE NOT LESS THAN 1-1/2" BETWEEN THE TWO. HANDRAILS INTERRUPTED BY NEWEL POST AT TURN ONLY.
6. SIZE OF HANDRAILS:
1-1/2" - 2" DIAM. OR MAX. 2-1/4" CROSS.
7. HAND RAILS SHALL BE SOLIDLY FIXED.
8. SPACE BETWEEN SPINDLES 4" MAX.
9. ALL FRONT PORCHES 6'x12' UNLESS SPEC'D BY P.M.
10. ALL PORCH STAIRS TO HAVE THREE (3) 2" x12" STRINGERS.
11. PORCH STEPS SHALL HAVE A CONCRETE PAD TO SUPPORT STAIR CARRIAGE THAT LEAVES A 4' x4' CLEAR LANDING @ BASE OF STEPS.
12. ALL EXTERIOR HANDRAILS TO BE 1-1/2" PAINTED PIPE OR SMOOTH METAL MOUNTED USING STANDARD HANDRAIL BRACKETS.

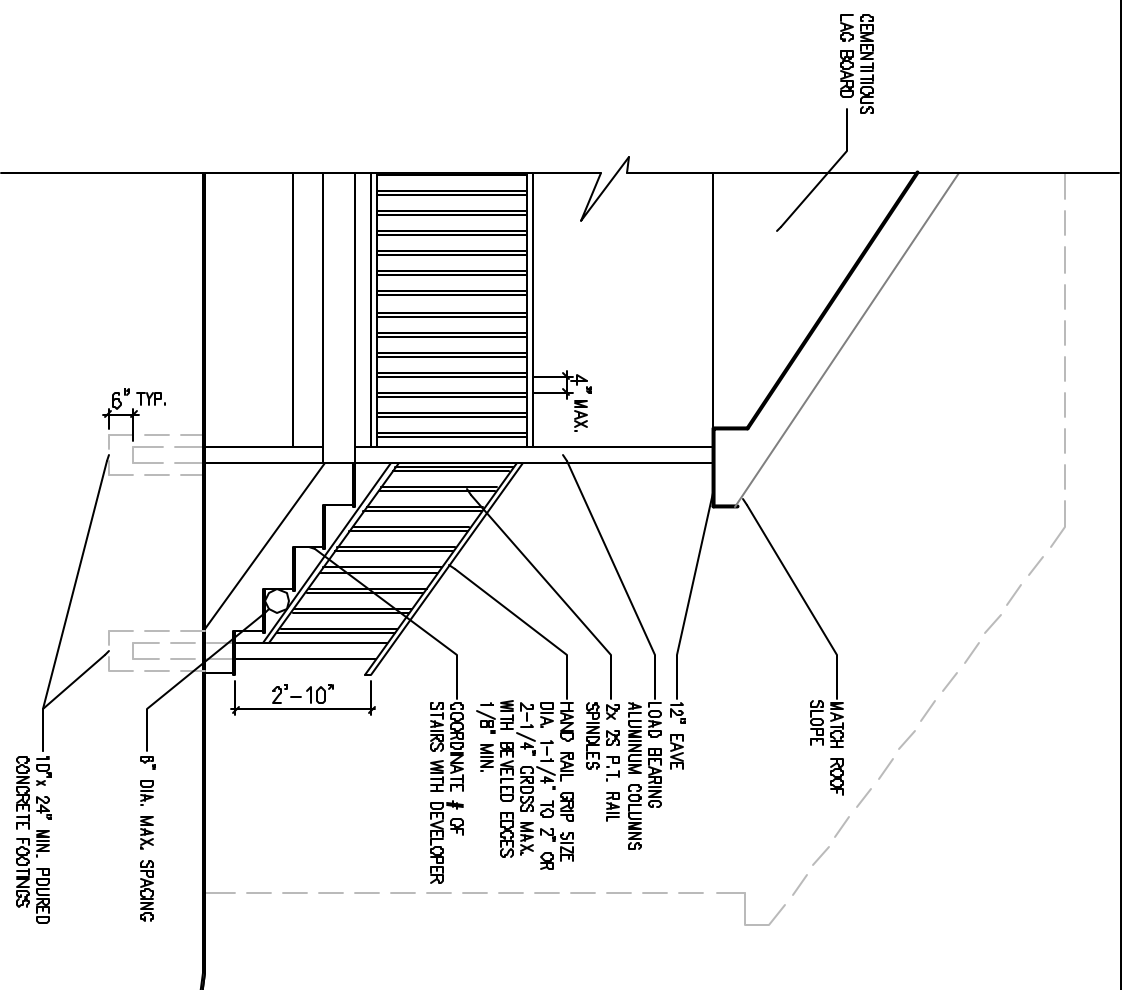

1 A.6 WOOD PORCH
SCALE: 1/4" = 1'-0"

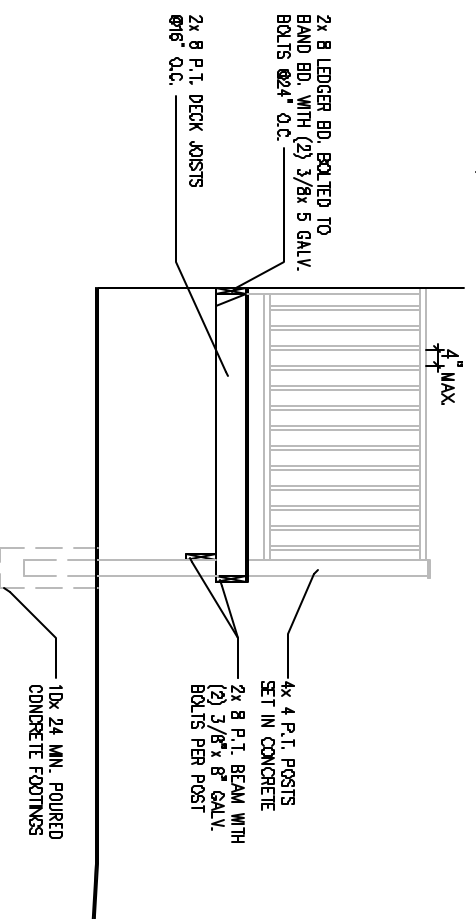

2 A.6 WOOD PORCH SECTION
SCALE: 1/4" = 1'-0"

0000

It is acknowledged and understood that the contractor shall be responsible for the construction and completion of the project and shall be liable for the cost of the project.

KRISS LOWRY & ASSOCIATES
CORINTH, KY.

PHOENIX RISING
ARCHITECTURAL DESIGN



A.6

The TYPICAL PORCHES
DATE: MARCH 3, 2014
REV
REV