

All drawings and written materials are the property of KLI & Associates, Inc. and shall remain the property of KLI & Associates, Inc. No part of this drawing may be reproduced or transmitted in any form or by any means, electronic, mechanical, photocopying, recording, or by any information storage and retrieval system, without the prior written permission of KLI & Associates, Inc.

**KLI & ASSOCIATES, INC.**  
 3522 Kirby Lane  
 Louisville, KY 40290  
 502.439.0896  
 Fax 502.240.1319

**KRISS LOWRY & ASSOCIATES**  
 CORINTH, KY.

3BED-1220-A



**PHOENIX RISING**  
 ARCHITECTURAL DESIGN

Sheet	A.1
Title	FLOOR PLAN
Date	JUNE 23, 2005
Rev	
Rev	
Rev	

- FLOOR PLAN NOTES:**
- STUD WALLS 2x 6 (5-1/2") @16" OR 24" O.C.
  - PLUMBING WALLS 2x 6 (5-1/2") @16" O.C.
  - FINISHED CEILING 8'-0" A.F.F.
  - LOAD BEARING HEADERS (2) 2x 10 WITH 1/2" PLYWOOD AND 2x 4 BASE MIN. DIMENSIONS TAKEN FROM FACE OF STUDS OR FOUNDATION
  - ALL DOORS STANDARD HEIGHT UNLESS NOTED
  - EXTERIOR DOORS TO HAVE EXTENDED JAMBS DESIGNED FOR 2x 6 WALLS

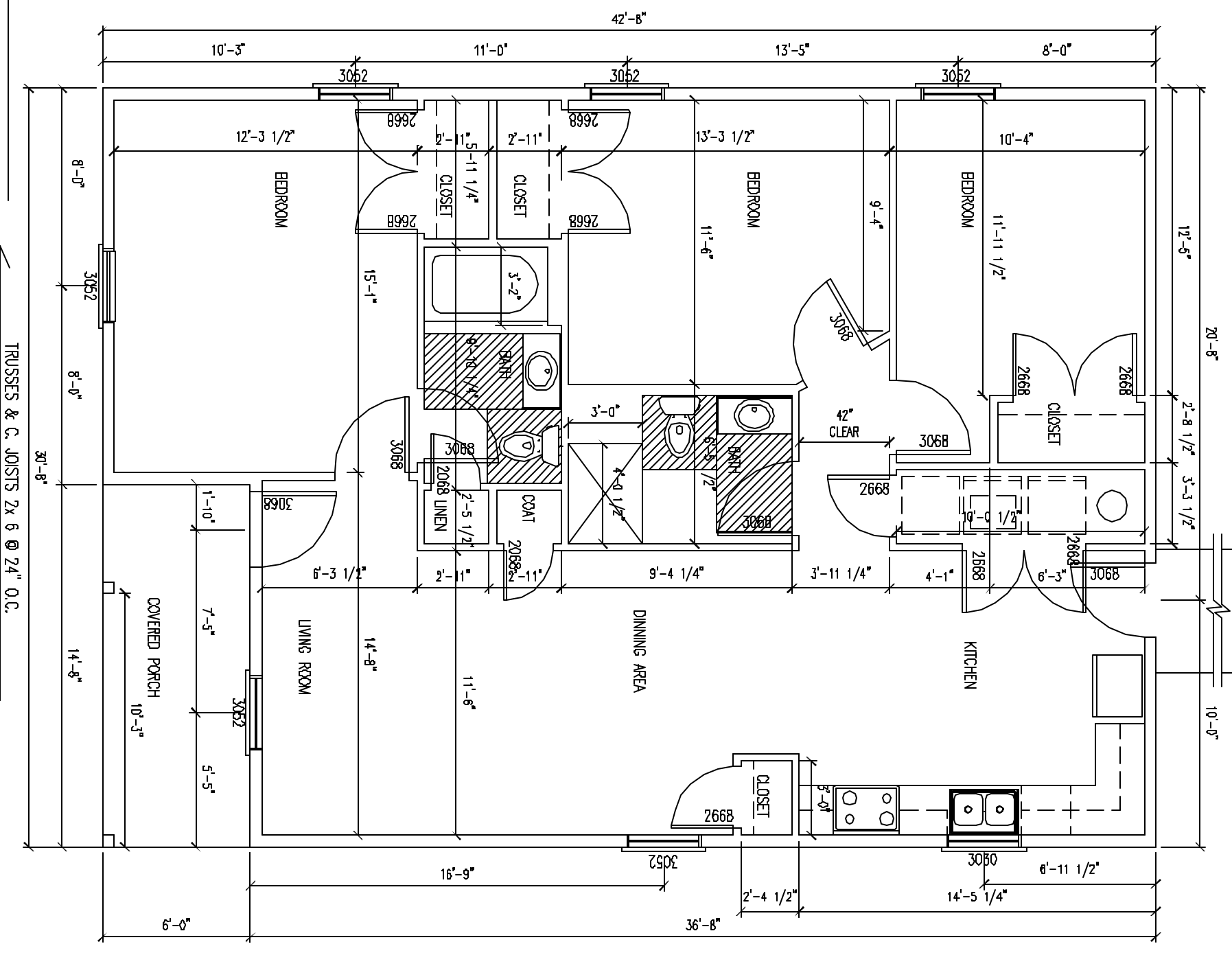

**FLOOR PLAN**  
 SCALE: 3/16" = 1'-0"

